

SURVEY STREET (WIDTH VARIES)

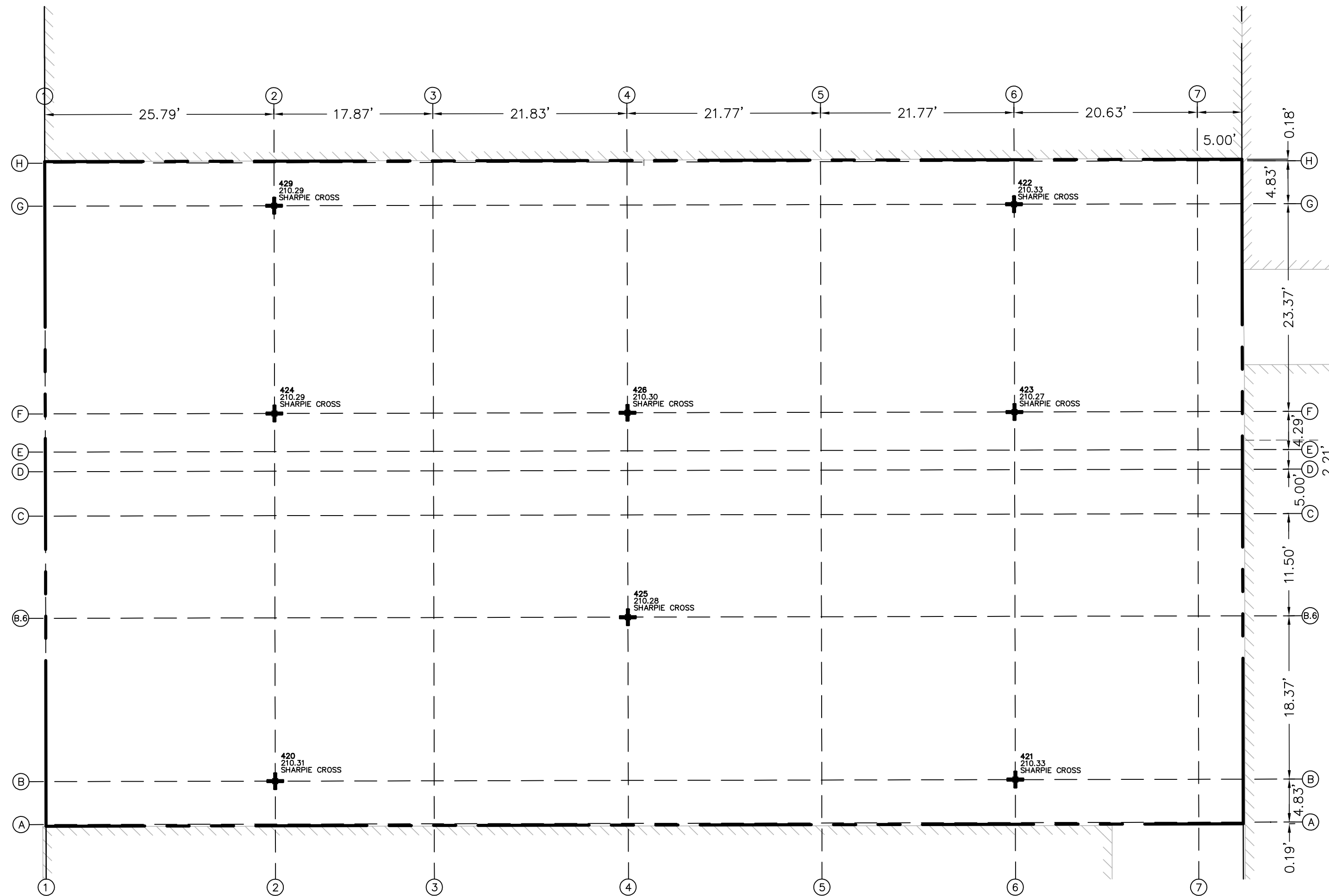

+ SET SHARPIE CROSS

STAKED ON: 08-30-2021  
REQUESTED BY: MORAN ENGINEERING CLIENT

## STAKING DIAGRAM

LOCATED AT 2072 SURVEY STREET  
CITY OF BERKELEY, COUNTY OF ALAMEDA, CALIFORNIA

AUGUST 30, 2021 SCALE: 1" = 10'

**MORAN ENGINEERING, INC.**

CIVIL ENGINEERS \ LAND SURVEYORS  
1930 SHATTUCK AVENUE, SUITE A  
BERKELEY, CALIFORNIA 94704  
(510) 848-1930

